

CITY OF REDMOND, WASHINGTON

ORDINANCE NO. 838

AN ORDINANCE annexing certain unincorporated territory in King County, Washington, to the City of Redmond, under Annexation No. A-77-5 and providing that such territory shall be assessed and taxed to pay its fair share of the existing indebtedness of the City and shall be subject to the Comprehensive Plan adopted by the City.

WHEREAS, a written Notice of Intent to Petition Annexation to the City of Redmond, No. A-77-5, was presented to the City Council on September 20, 1977, signed by property owners owning in excess of 10% in value, according to the assessed valuation for general taxation purposes, of the property described therein; and

WHEREAS, the City Council held a meeting with the initiating parties on October 4, 1977, and indicated it would view favorably the proposed annexation, provided legal requirements were met, and that the proposed Petition for Annexation should contain a requirement that the area to be annexed assume its fair share of the existing indebtedness of the City and be subject to the Comprehensive Plan adopted by the City, which included such territory; and

WHEREAS, a written Petition for Annexation No. A-77-5, was presented to the City Council on November 1, 1977, requesting annexation of the territory described therein, which Petition provided that the property within the territory to be annexed shall be assessed and taxed to pay for the outstanding City indebtedness contracted prior to, or existing at, the date of annexation and that the territory to be annexed shall be subject to the Comprehensive Plan adopted by the City which included such territory, and the Petition contained a quotation of the minute entry of such requirements made by the City Council; and

WHEREAS, the City Council caused such Petition to be examined, and it has been certified to contain signatures of owners of property in excess of 75% in value, according to the assessed valuation for general taxation purposes, of the property described therein, and in all other respects has met the requirements of the laws of the State of Washington concerning annexation of unincorporated areas by cities under the petition method; and

WHEREAS, the proposed annexation was duly filed with the Boundary Review Board of King County, Washington, (BRB No. 747) and said Board thereafter advised the City that on May 15, 1978, a Resolution and Hearing Decision was filed by said Board approving the subject annexation following a public hearing upon a request for review pursuant to RCW 36.93.100(1) or (2); and

WHEREAS, the City Council set the date of July 18, 1978, at 8:00 P.M. as the date and time for a public hearing on the proposed annexation, and caused Notice of Hearing to be published and posted in accordance with law, and the hearing having been duly held; and

WHEREAS, it appears to the City Council that the proposed annexation of the territory described below will be for the general benefit of the City of Redmond and the general benefit of the area to be annexed, Now, Therefore,

THE CITY COUNCIL OF THE CITY OF REDMOND DO ORDAIN AS FOLLOWS:

Section 1. Territory annexed -- description. The following described territory, situated in King County, State of Washington, and depicted on the sketch or map on the attached Exhibit "A" is hereby annexed to the City of Redmond, Washington, to wit:

That portion of the east 1/2 of Section 1, Township 25 North, Range 5 East, W.M., and the northeast 1/4 of Section 12, Township 25 North, Range 5 East, WM, described as follows:

Commencing at the southeast corner of Section 1, Township 25 North, Range 5 East, thence north along the east line of Section 1, Township 25 North, Range 5, to the point of intersection with the south right-of-way margin of State Aid Road No. 1, AKA Union Hill Road, and the point of beginning;

Thence westerly along the south right-of-way margin of State Aid Road No. 1. AKA Union Hill Road, to the point of intersection with the westerly right-of-way margin of Redmond Bear Creek Road No. 1354, AKA Avondale Road;

Thence northeasterly along the westerly right-of-way margin of Redmond Bear Creek Road, AKA Avondale Road to a point on a line 30' west of the east line of Section 1;

Thence south along a line 30' west of the east line of Section 1 to the north line of the southeast 1/4 of Section 1;

Thence east along the north line of the southeast 1/4 of Section 1 a distance of 30' to the east line of Section 1;

Thence south along the east line of Section 1, Township 25 north, Range 5 to the point of intersection with the south right-of-way margin of State Aid Road, No. 1, AKA Union Hill Road, and the true point of beginning.

All situate in King County, Washington.

Section 2. Territory subject to existing indebtedness of City. The above described territory shall be assessed and taxed at the same rate and on the same basis as the property within the City of Redmond is assessed and taxed to pay for the outstanding indebtedness of the City of Redmond contracted prior to or existing at the date of annexation and thereafter enacted.

Section 3. Territory subject to Comprehensive Plan of City. The above described territory shall be subject to the Comprehensive Plan of the City of Redmond which has been adopted and includes such territory. Until such time as the territory hereto annexed to the City of Redmond is zoned and classified pursuant to Section 17.72.010 of the Redmond Municipal Code, the zoning in effect under the previous governmental authority shall remain in force as interim zoning and shall be administered in accordance with regulations contained in Title 17 of the Redmond Municipal Code which apply to similar zoning classifications.

Section 4. Effective date of annexation. The above described territory shall be annexed to and become a part of the City of Redmond for all purposes on and after August 20, 1978, which shall be the effective date of this annexation.

Section 5. Certified copies to be furnished and filed. The Planning Director shall file certified copies of this ordinance with the Office of the County Executive of King County, Washington, and shall obtain and file in duplicate with the State Census Board the required certificate relating to determining the population of the annexed area. Certified copies of this ordinance shall also be transmitted to the Secretary of State and the Planning and Community Affairs Agency of the State of Washington.

Section 6. Effective date. This ordinance shall take effect and be in force five (5) days after the date of its publication in the manner provided by law.

PASSED by the Council of the City of Redmond, Washington, at a regular meeting thereof, and APPROVED by the Mayor this 15TH day of August, 1978.

CITY OF REDMOND

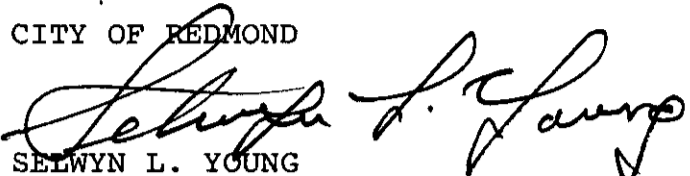
SELWYN L. YOUNG
MAYOR

ATTEST:

PAUL F. KUSAKABE
CITY CLERK

APPROVED AS TO FORM:

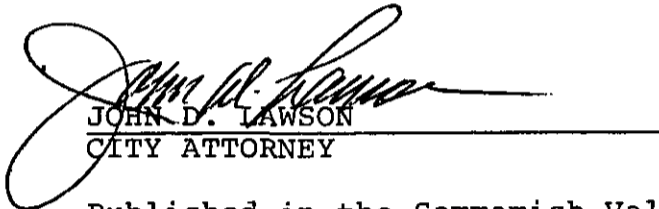
JOHN D. LAWSON
CITY ATTORNEY

Published in the Sammamish Valley News on August 23, 1978

Zambruski file

V.14

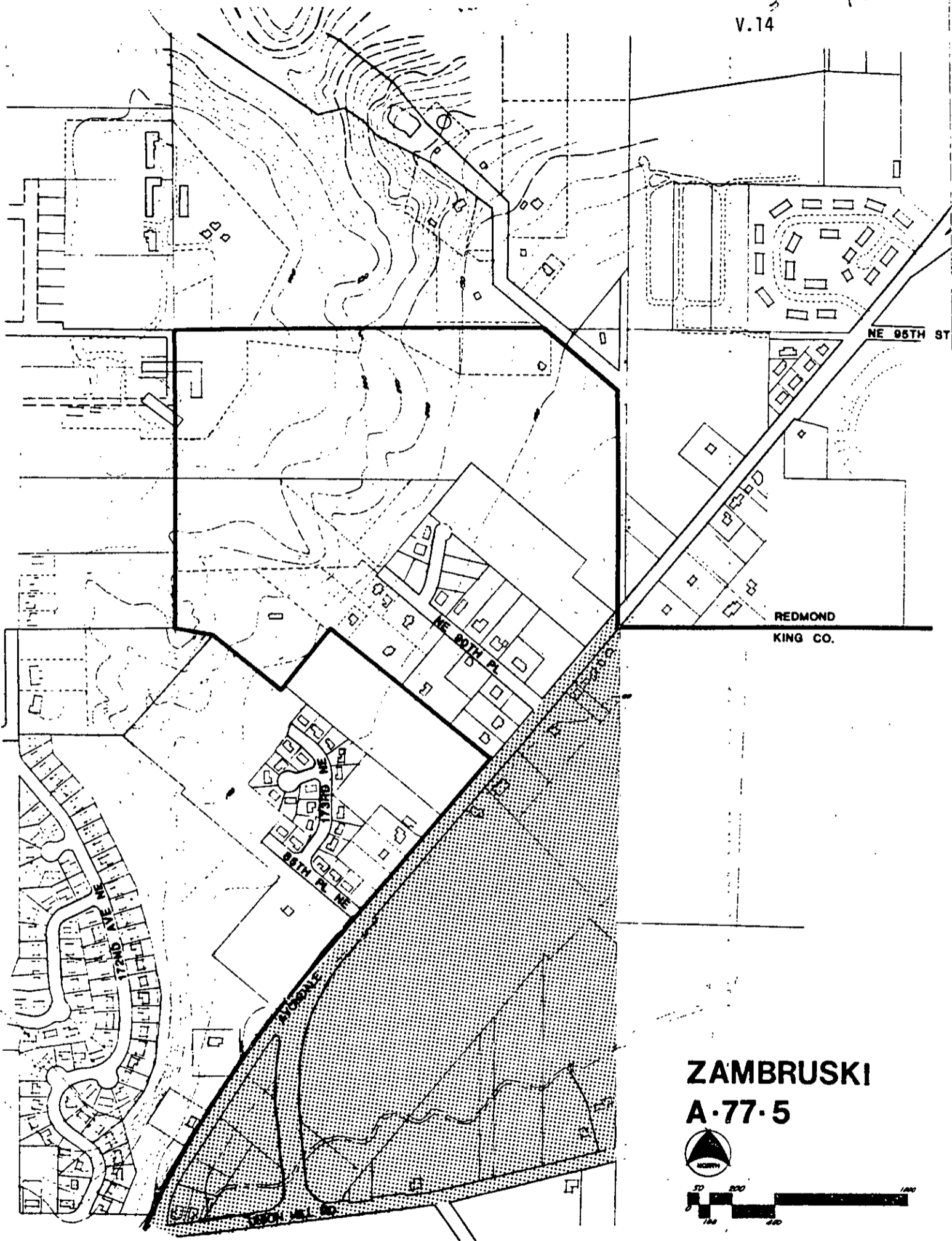

REDMOND
KING CO.

**ZAMBRUSKI
A-77-5**



Exhibit "A"

Ordinance No. 838

Zambruski Annexation A-77-5